

March 29, 2005

**Surf City Community Park & Recreation Center
Surf City, North Carolina**

EDA Project No. 2004425.00

Addendum No. 2

The following addendum supersedes all previous information and does hereby become part of the contract documents.

Sheet C-1, C-2, C-3:

- Provide 5' wide by 4' thick 3,000 PSI concrete walk from the new entrance drive to the west property line. See attached BL-1 for extents and detail 05/C-8 within construction documents.
- Power service to the new transformer to be provided by Jones/Onslow EMC (800) 682-1515. From pole to transformer shall be underground. The Contractor shall be responsible for service from the transformer into the building. If service to the transformer has associated cost then the Owner is responsible for the cost. All associated cost from the transformer to the building, including the transformer concrete pad, shall be responsibility of the Contractor. See drawing BL-2 for revised transformer location.
- Revise Picnic Shelter Model number from Hex 16 MP to Hex 16 MR. The shelter components and foundation shall be designed by the Manufacturer for 130 MPH wind zone minimum and all steel shall have (1) coat of E coat and (1) poly powder coat finish. Color selection by Owner.

Sheet A-2, Room Finish Schedule:

- Ceramic tile as called for to be 2"x2"x1/4" unglazed ceramic mosaic tile.
- Wall base to be 4"x 4".
- Tile products shall be by American Olean, Dal-Tile or Summitville or approved equal products.
- Tile setting and grouting materials shall be similar manufacturers.
- Provide marble thresholds at all similar finish transition from ceramic tile to other floor finishes.
- Provide mildew resistant silicone sealants on all grout joints.
- Colors to be selected from Manufacturers standard color selection.
- Upon completion of placement and grouting clean all ceramic tile surfaces so they are free of foreign matter.
- Apply a protective coating of neutral protective cleaner to all completed tile floors and bases.

Sheet E-2:

- At Gymnasium exit doors 108 E&F only (1) illuminated exit sign is required in lieu of (3).
- At Gymnasium exit doors 108 B only (1) illuminated exit sign is required in lieu of (2).
- Clarification – Gym lighting contractor panel shall be located in Electrical Room 112.1. The energizing switch shall be located on rigid frame enclosure beside Door 100B.
- Site lighting and tennis court lighting shall be leased and by others.
- MC cable will be allowed for light fixture whips. Contractor also may provide MC cable to low bay lights with Aircraft cable supports.
- Clarification – all fire alarm wiring is to be fully installed in conduit.

Sheet S-2 General Notes

- D.6 – Reductions will be allowed as per specifications Section 13122 – B.2.

Specifications:

Section 00820 – Special Conditions

- Clarification of item # 5

Revise to as follows: This project involves grant money, which has specific time limits. Therefore, the following items need to be constructed concurrently and to the minimum level of completeness as indicated below:

- Recreation Center Building: Building to be completely in the dry and all plumbing, HVAC and electrical roughins complete.
- Parking Lot and Drives: (100% paved if alternate accepted), (100% graveled if alternate not accepted).
- Sidewalks 100% complete.
- Tennis Courts 100% complete.
- Tennis Court Lighting – Contractor to coordinate installation of leased lights by Utility Company.
- Site Preparation: All grading complete and at a minimum temporary seeding.
- Landscaping: All Landscaping complete except around building and permanent seeding (plants to be utilized around building to be stored on site.)
- Playground: 100% complete
- Walking Trails: 100% complete
- Picnic Shelter: 100% complete
- Stormwater Facilities: 100% complete

Note: The contractor to maintain all items until the entire project is complete.

Section 00830-1 Alternate # 5 & Section 10500 Lockers

- General Storage System is an approved Manufacturer for lockers
- 4 inch solid base is acceptable for lockers
- Elipse Corridor Lockers with 14 gauge doors by General Storage Systems is acceptable (800) 265-9055

Section 09624 – Synthetic Sports Flooring System

- Part 1 General, 1.1-A-1 – Clarification:
Synthetic Sports Flooring system shall be in the Gymnasium and it's associated stage area. The Exercise/Weight room shall also have synthetic flooring. See 2.3 materials for specific floor requirements per area.

Section 11480 – Athletic Equipment

- 2.1.B Manufacturers – AALCO is an approved manufacturer.
- Goal shall be folding in lieu of fixed

Section 13122-Metal Building Systems

- Star Buildings metal building system is approved equal.
- 1.2.D – revise to... The minimum vertical clearance from finish floor to underneath frame shall be 18'-0" and 20'-0" over basketball court area.

General Clarification

- Building permitting and inspections shall be by the Town of Surf City building inspections department.
- The Contractor shall pay for all required testing. See specification section 01410.
- Contractor to provide on the bid form a unit cost for (1) cubic foot of cut and backfill in case of unsuitable soils.

END OF ADDENDUM NO. 2

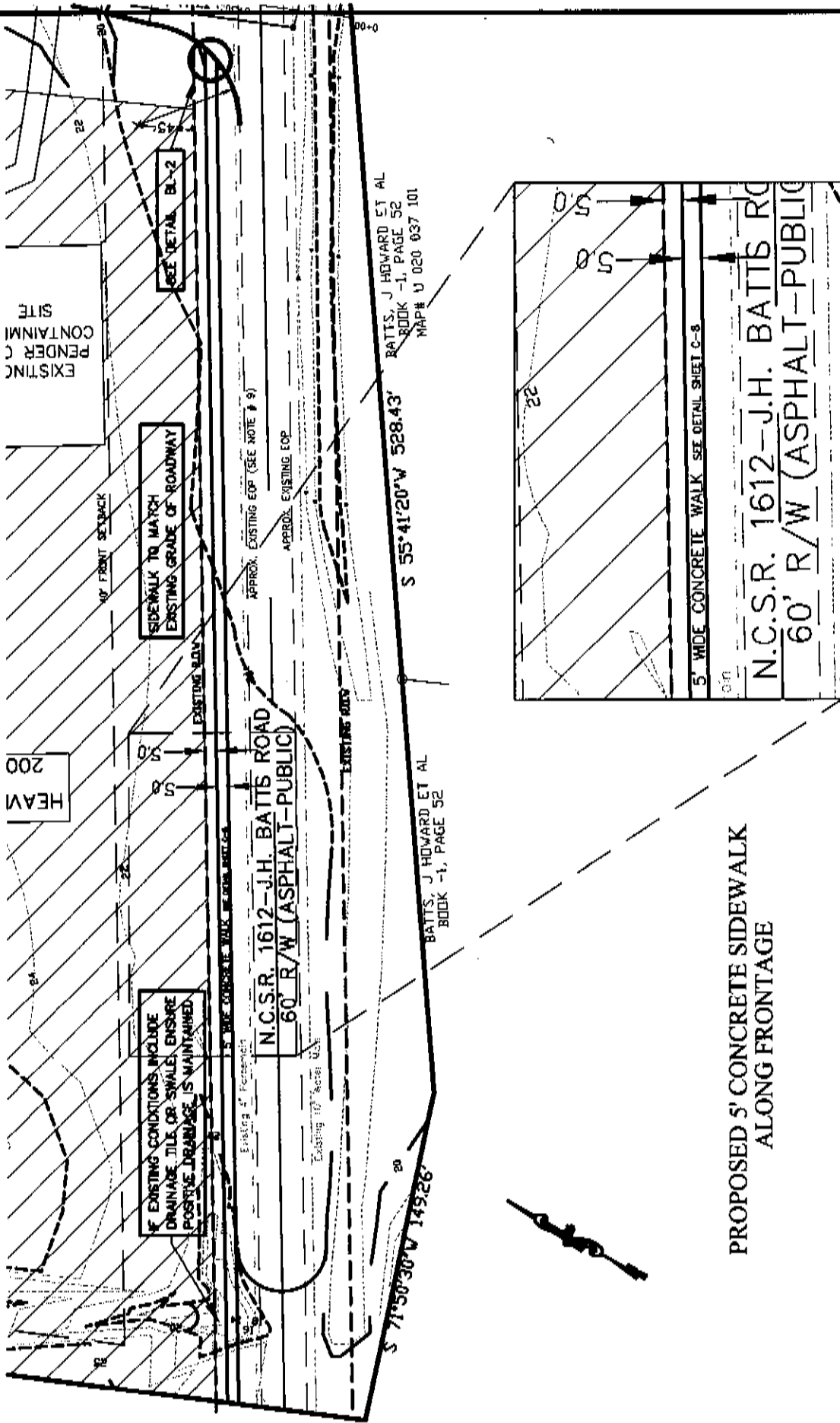

PROPOSED 5' CONCRETE SIDEWALK
ALONG FRONTAGE

2004425
 SHEET NO.
BL-1

**SURF CITY COMMUNITY PARK
& RECREATION CENTER**
 SURF CITY, NORTH CAROLINA

EDA
 ENGINEERS ARCHITECTS
 361 Orange Ave., Suite 103
 Raleigh, NC 27601
 Phone: 919.833.1111
 Fax: 919.833.1112
 www.eda-engineers.com

THIS DRAWING REFLECTS
 CHANGES MADE AS PER
 THE TOWN OF SURF CITY
 REVIEW

EXISTING
 PENDER C
 CONTAINMI
 SITE

40' FRONT SETBACK
 SIDEWALK TO MATCH
 EXISTING GRADE OF ROADWAY

IF EXISTING CONDITIONS INCLUDE
 DRAINAGE TILE OR SWALE ENSURE
 POSITIVE DRAINAGE IS MAINTAINED

N.C.S.R. 1612-J.H. BATTIS ROAD
 60' R/W (ASPHALT-PUBLIC)

BATTIS, J HOWARD ET AL
 BOOK -1, PAGE 52
 MAP# U 020 037 101

BATTIS, J HOWARD ET AL
 BOOK -1, PAGE 52

5' WIDE CONCRETE WALK SEE DETAIL SHEET C-8

N.C.S.R. 1612-J.H. BATTIS ROAD
 60' R/W (ASPHALT-PUBLIC)

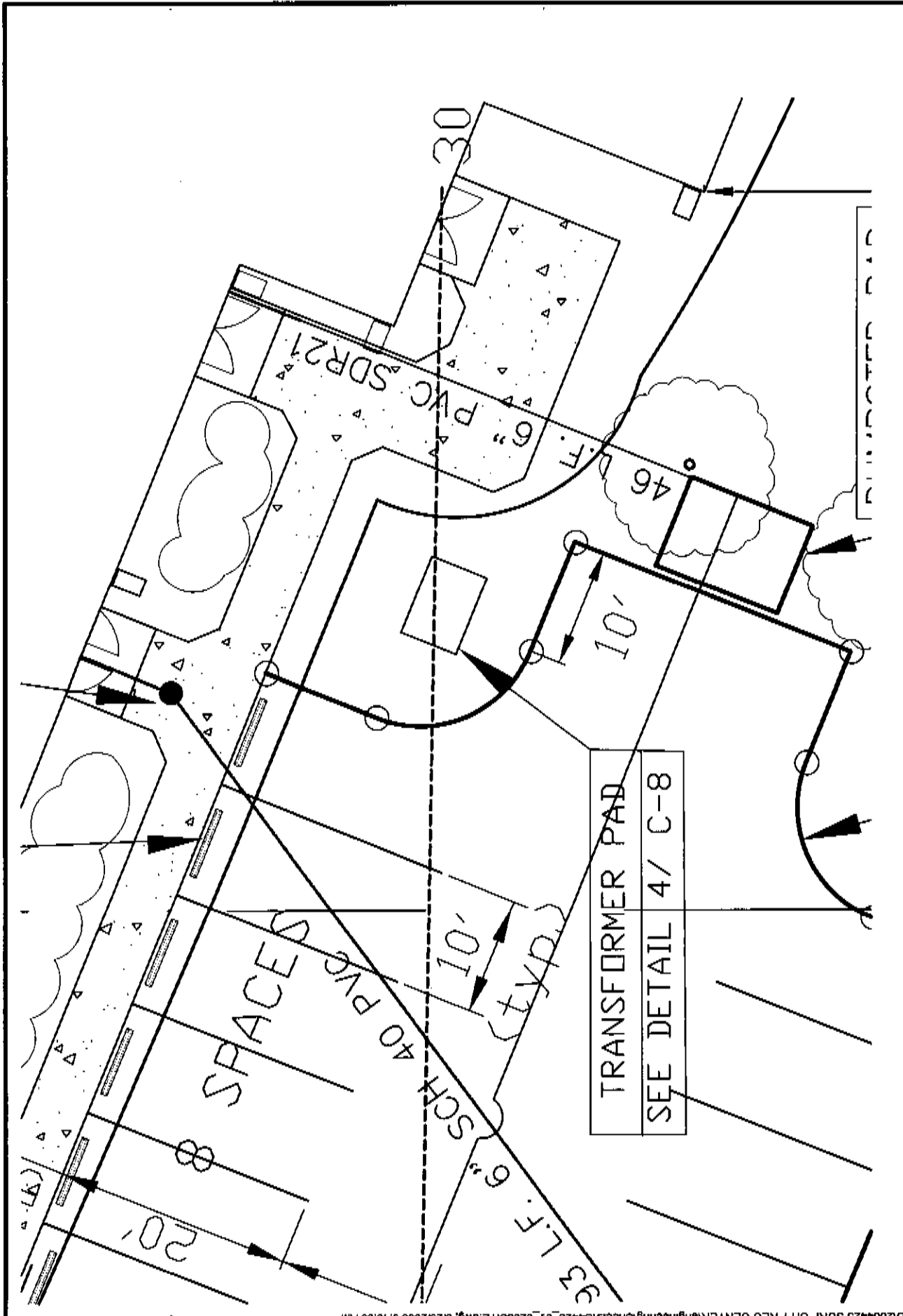

THIS DRAWING REFLECTS CHANGES MADE AS PER THE TOWN OF SURF CITY REVIEW

301 Ochs Avenue, Suite 100
 Raleigh, NC 27601
 Telephone: 919.876.1000
 Fax: 919.876.1001

ED A
 pa north carolina
 Architects o Engineers o Planners

SURF CITY COMMUNITY PARK & RECREATION CENTER
 SURF CITY, NORTH CAROLINA

2004425	
ISSUED:	
DWG BY:	
CHK BY:	
REVISIONS	
5/17/08 SIDEWALK CHG	
SHEET NO.	BL-2